

Grouser, Wear, & Profile Bars

VERSATILE WELD-ON WEAR PROTECTION

Use: Grouser bars have multiple uses for a variety of wear applications. These versatile, weldable and wear resistant profiles can be cut to length and are especially good to protect bucket cheeks and cover joints.

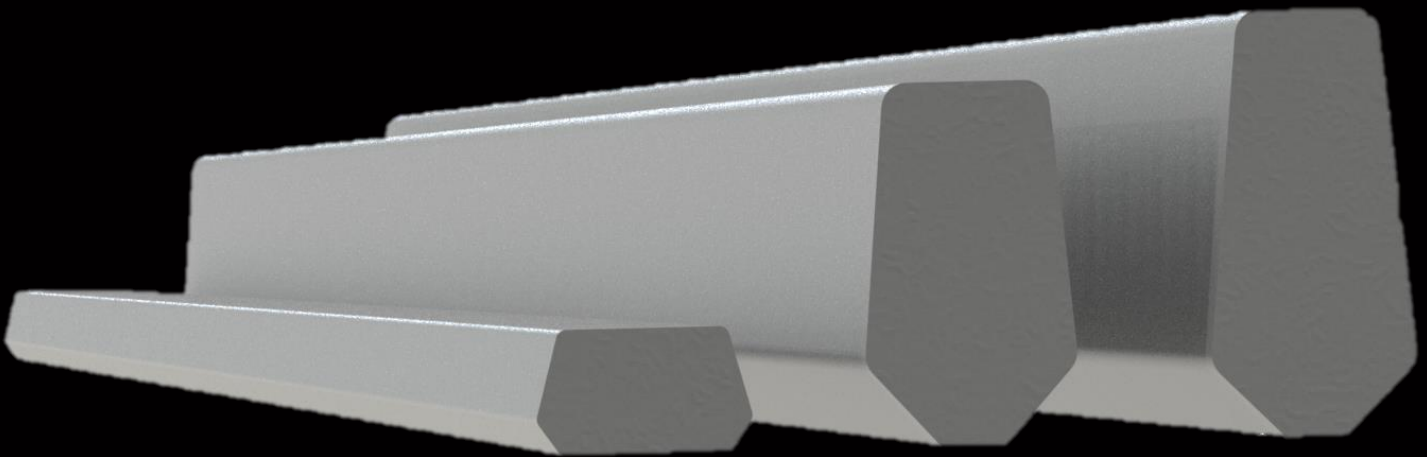
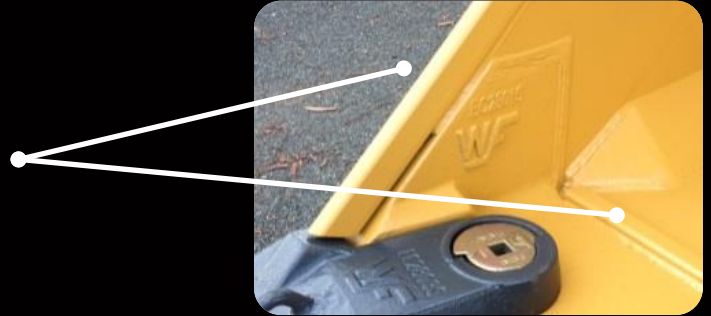

Benefits:

- Decreased associated down time of bucket or machinery
- Prolonged service life.
- Reduced maintenance costs

available in various sizes for all applications

Grouser Bar Specifications

Hardness: 500 BHN
Standard length: 3050mm / 10ft

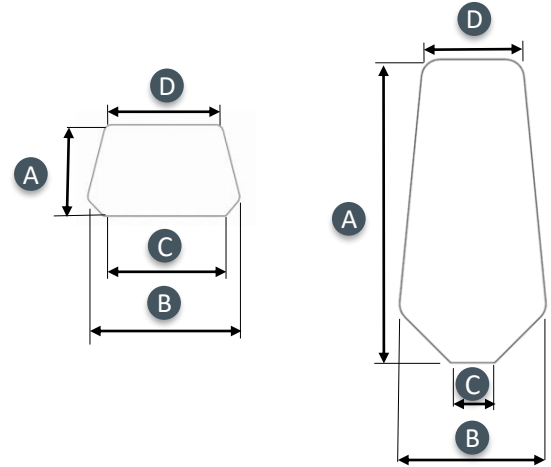
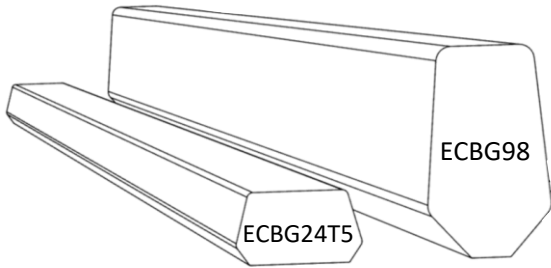

Grouser Bar

Product Code	Weight per meter	A	B	C	D
ECBG24T5	7.1kg 15.65lbs	24mm 0.945"	42mm 1.65"	33mm 1.299"	33mm 1.299"
ECBG98	16.1kg 35.5lbs	65mm 2.56"	37mm 1.46"	15mm 0.59"	29mm 1.14"

Wear Bar

Product Code	Weight	Length	Width	Thickness	Steel	Hardness
ECWB50-1003500	136kg 300lbs	3500/ 137.8"	100mm 3.93"	50mm 1.97"	QT450	450BHN
ECWB40-1003500	109kg 240lbs	3500/ 137.8"	100mm 3.93"	40mm 1.57"	QT450	450BHN
C4800-50WB	136kg 300lbs	3500/ 137.8"	100mm 3.93"	50mm 1.97"	C4800	470BHN work hardens

Profile Bar

Product Code	Weight	Length	Width	Thickness	Steel	Hardness
C4800-50PB	140kg 309lbs	3530/ 139"	100mm 3.93"	50mm 1.97"	C4800	470BHN work hardens
C8000-50PB	140kg 309lbs	3530/ 139"	100mm 3.93"	40mm 1.57"	C8000	540BHN work hardens
QT450-50PB	140kg 309lbs	3530/ 139"	100mm 3.93"	50mm 1.97"	QT450	450BHN
QT450-40PB	111kg 245lbs	3530/ 139"	100mm 3.93"	40mm 1.57"	QT450	450BHN

Disclaimer: product information correct at time of publication, information may be modified without prior notice always follow the correct installation procedures whilst taking the necessary precautionary measures.

Complementary products - Full Bucket protection

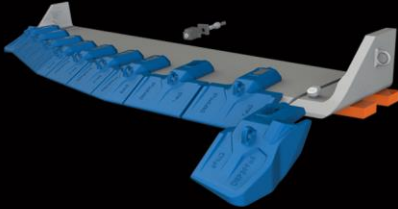

Shroud systems

We have a range of mechanical, weld-on and bolt-on underground shroud systems that can adapt to your machine and site needs.

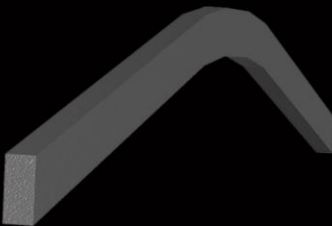

Wearstrips and profile bars

With onsite cutting facilities, we recommend that our customers use C4800 or C8000 - an advanced high resistant performance steel with better wear properties than conventional Q&T plate - for all profile bars and strips to protect their buckets and extend shroud wear-life.



Heelblocks, Gussets + more

We have a range of heelblocks and additional castings especially designed for LHD machines, which protect the under edges, top corners and internals from wear and impacts.

Wearplate

Cut and rolled to your requirements, we can supply you with wear skins for your buckets manufactured from QT450 grade plate or similar.

Head office - Australia
Address 533 Abernethy Road,
Kewdale, Western Australia 6105
Tel +61 (0) 8 9353 6111
Fax +61 (0) 8 9353 6188
Email sales@wearforce.com.au

www.wearforce.com.au

Kalgoorlie Branch- Australia
Address 5 Hudson Place, West
Kalgoorlie, Western Australia, 6430
Tel +61 (0) 8 9022 8035
Fax +61 (0) 8 9022 8032
Email sales@wearforce.com.au

www.wearforce.com.au

North American Office
Address 359 New St,
Quakertown, PA 18951, USA
Tel +1 (215) 996 1770
Fax +1 (215) 822 1423
Email sales@wearforcena.com

www.wearforcena.com